Mechanical & Electrical.

Engine: BMC 1.5 Gearbox: Hurth Hydraulic Cooling: Skin tank
Calorifier feed: No
Bowthruster: No
Weed hatch: Quick release Stern gland greaser: Remote
Bilge pump: 12v
Batteries: 12v Domestic: 2 Engine: 1
240v: shore only Inverter: No Charger: No Generator: No

Interior.

Lining - floor to gunwale: Brown carpet.
Lining - gunwale to ceiling: Varnished timber board
Lining - ceiling: White timber board.
Bulkheads:
Flooring: Wood, varnished timber boards, tiles.
Lighting: 12v fluorescent
Cabin heating: Solid fuel stove
Insulation: Celotex boards
Water heating: Morco gas heater
Headroom: 6'6"

ACCOMMODATION (From aft)

Cabin Arrangement: Double cabin, Bathroom, Galley, Saloon

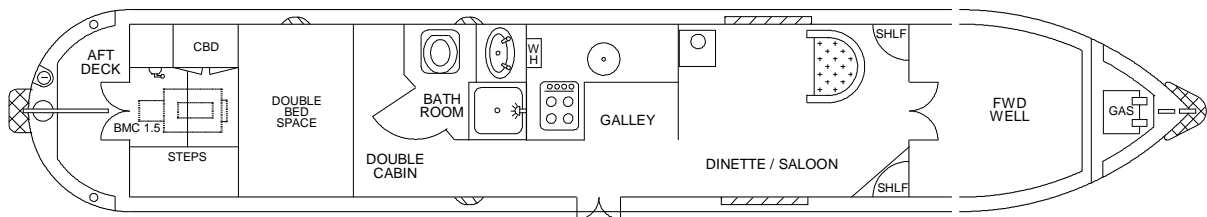

Berth arrangement: - fixed double in own cabin

Double cabin: Double bed without a mattress going width ways to stern, storage beneath. Door to port into ...



Bathroom: Porta potti to aft. Inset white plastic basin forward. Stand in shower to. Passageway continues forward into ...

Galley: Free standing 4 gas hob oven and grill cooker to aft centre. Counter tops with cupboards beneath to port. Single inset stainless steel sink built into counter top. Cupboard above. Open plan forward into ...



Saloon: Solid fuel stove to port aft. Table and chair going forward. Folding desk to starboard with glass cabinets both sides of it. Steps up to forward well deck.

This boat has been cleared and will be sold as viewed.

GENERAL

Berth transferable: Possible cruising berth by arrangement

Sale type: Private

VAT status: The VAT status of this vessel is not known.

Viewing: High Line Yachting, Mansion Lane, Iver, SL0 9RG
9am to 6pm Tuesday to Saturday, 11am to 5pm Sunday, closed Monday.

PLEASE NOTE

In this case we are acting as Brokers only.

Whilst every care has been taken in their preparation, the correctness of these particulars is not guaranteed.

The particulars are intended only as a guide and they do not constitute a term of any contract.

A prospective buyer is strongly advised to check the particulars and where appropriate at his own expense to employ a qualified Marine Surveyor to carry out a survey and / or to have an engine trial conducted which if conducted by us shall not imply any liability for such engine on our part.

The Vendor is not selling in the course of a business.

The VAT status of the vessel is not known, unless otherwise stated.

All sales subject to contract. No guarantee is given or implied as to the condition or legal title.

No appliances or systems have been tested. All measurements stated are approximate.

© Virginia Currer Marine Ltd 2020

Accredited members of

