VECHTLUST

£135,000

General.

<i>Builder:</i> Tjalk	<i>Type:</i> Sailing Groniger Tjalk	
<i>Fitted:</i> Refitted	<i>Year:</i> 1910	
<i>Length:</i> 49ft (15m)	<i>Beam:</i> 10ft 5in (3.10m) <i>Draught:</i> c2ft (0.6m)	
<i>Lying:</i> London		
<i>CRT no:</i> 111278	<i>CIN No:</i> N/A	<i>BSC to:</i> 11/2020

History

This vessel is lying on a residential transferable mooring in London. The boat has been refitted inside and is designed as a flat, all 240v. Last survey report carried out in France in 2008.

Hull & Exterior.

Material / build: All steel.



Exterior: Black bitumen painted hull to rubbing band. Brown from rubbing band through side decks, cream cabin sides and brown roof.

Windows: Anodised aluminium non opening at the aft end and opening portholes at the forward end.

Roof: Sliding hatch over access aft. Tubular hand rails, 2 pigeon boxes and mast.

Aft deck: Large stern with steel bench around the stern with storage below. Large wood ruder. Two central ½ glazed timber doors to accommodation.

Mechanical & Electrical.

Engine: Indenor / Peugeot 67hp (not functioning)

Bilge pump: 12v

Batteries: 12v

240v: Yes

Inverter: No

Charger: No

Generator: No

Interior.

Lining - floor to gunwale: White painted panelling

Lining - gunwale to ceiling: As above

Lining - ceiling: As above

Flooring: Laminate with inspection hatches

Cabin heating: Dimplex electric

Water heating: Heatrae Sadia Multi point 50

Headroom: 6ft 8in

ACCOMMODATION (From aft)

Cabin Arrangement: Saloon, Galley, Double cabin with on suite

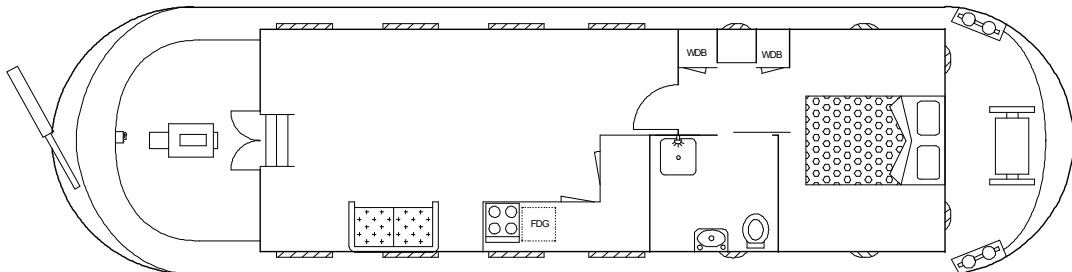

Berth arrangement: 2- fixed double in own cabin

Saloon: Designed for free standing furniture, currently comprises a two seater sofa to starboard. The full length of the cabin to port has integrated under gunnel cupboards. Inset is the cupboards is the Dimplex heater. Open plan forward into ...



Galley: The galley is L shape located to starboard with solid wood work surfaces and white cupboards below. AEG 240V fridge, Inset Miele induction 4 ring hob with grill and oven below. Inset single bowl stainless steel sink and drainer unit. Door continues forward into ...

Double cabin: As to enter the cabin there is a small section of worksurface with full height wardrobes to each side. Opposite is a sliding door to access the bathroom. The double bed is located in the centre of the cabin against the forward bulkhead with interior sprung mattress c.6ft3in x4ft and shelf units to each side.



Bathroom: Designed as a wet room, fully tiled white wall and black tile floor. Pump out toilet permanently connected to drain. White sink mounted on the wall with mirror fronted cabinet above.

This boat has not been cleared and personal possessions will be removed prior to sale.

GENERAL

Berth transferable: Residential berth by arrangement

Berth fees: 12,000 per annum

Sale type: Private

VAT status: The VAT status of this vessel is not known.

Viewing: By Appointment

Mooring:

Facilities:

Electric charging point

Parking

Refuse disposal

Toilets and shower

Water point

Electric

Postal address

Washing and Laundry services

Electricity is metered and billed quarterly, water at present is included.

Secure moorings overseen by an on sight office and security managed 24/7 by the quay manager and accessible only through keypad locked doors.

Lift for wheelchair access and a static pontoon on entry.

The moorings have toilet and washing facilities, along with a the provision of storage.

Located next to the restaurant The Commissary and also the photo studio Holborn Studios .

The moorings are located on the Regents Canal between Angel and Kingsland Road, on the Hackney/Islington border and just a short walk to the City of London. In the surrounding Hoxton and Islington area, there are plentiful shops, restaurants, offices and theatres.

Nearest stations
Essex Road (0.5mi.)

Angel (0.6mi.)
Northern Line

Old Street (0.6mi.)
Northern Line

PLEASE NOTE

In this case we are acting as Brokers only.

Whilst every care has been taken in their preparation, the correctness of these particulars is not guaranteed.

The particulars are intended only as a guide and they do not constitute a term of any contract.

A prospective buyer is strongly advised to check the particulars and where appropriate at his own expense to employ a qualified Marine Surveyor to carry out a survey and / or to have an engine trial conducted which if conducted by us shall not imply any liability for such engine on our part.

The Vendor is not selling in the course of a business.

The VAT status of the vessel is not known, unless otherwise stated.

All sales subject to contract. No guarantee is given or implied as to the condition or legal title.

No appliances or systems have been tested. All measurements stated are approximate.

© Virginia Curren Marine Ltd 2019

Accredited members of

