DELICIA

£27,500

General.

Builder: Colecraft*Type:* Semi-Traditional stern*Fitted:* Refitted*Year:* 1991*Length:* 46ft (14m)*Beam:* 6ft 10in (2.1m) *Draught:* c2ft (0.6m)*Lying:* High Line Yachting, Iver*CRT no:* 49010*CIN No:* N/A*BSC to:* 02/2020

History

The vessel was last out of the water for blacking in 2016 with Bitumen and the last survey report was carried out in 2014.

Hull & Exterior.

Material / build: All steel. Thicknesses: 10 – 6 - 4mm



Exterior: Black bitumen painted hull to rubbing band. Blue from rubbing band through side decks, with non slip finish to side decks. Blue cabin sides with cream coachline and name sign written at the stern. Roof in grey.

Windows: Anodised aluminium top hopper opening, portholes and opening side doors to starboard.

Forward well: Rope fender. Steel cants. 'T' stud. Gas locker. Self draining steel well deck, storage lockers / bench to each side. Two central half glazed varnished timber doors to accommodation.

Roof: Integral steel hand rails, pole, TV areal, mushroom vents, flue for Alde and flue for solid fuel stove.

Aft deck: Rope fender, 2 mooring dollies, steel cants, diesel filler. Tiller steering. Self draining deck. Two central timber lined steel doors into semi trad with storage locker to each side. Steps down to starboard with door into accommodation.

Mechanical & Electrical.

Engine: Lister LPWS3 Gearbox: PRM Delta Cooling: Skin tank
Calorifier feed: Yes
Bowthruster: No
Weed hatch: Quick release Stern gland greaser: Remote
Bilge pump: 12v
Batteries: 12v Domestic: 3 Engine: 1
240v: Yes Inverter: No Charger: Sterling Pro Charge Ultra 30amp
Generator: No
Galvanic voltage indicator

Interior.

Lining - floor to gunwale: Pine panelling
Lining - gunwale to ceiling: Pine horizontal tongue and groove
Lining - ceiling: As above
Flooring: Carpet
Lighting: Led
Cabin heating: Alde heating large radiators in cabin and saloon, solid fuel stove
Insulation: Polystyrene
Water heating: Alde and engine
Headroom: 6ft 3in

ACCOMMODATION (From aft)

Cabin Arrangement: Double cabin, Bathroom, Galley, Saloon

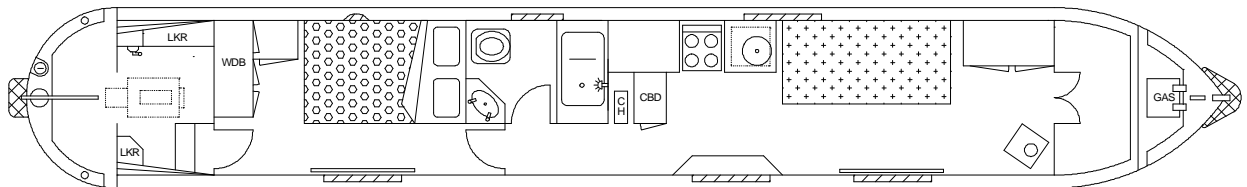

Berth arrangement: 4 berth - fixed double in own cabin and convertible double in saloon

Double cabin: Against the aft bulk head is a full height wardrobe and further two large cupboards giving access to the calorifier. The double bed is lengthways to port with interior sprung mattress c.6ft3in x 4ft, with open storage below, shelf mounted on the forward bulkhead with reading lamps. Door continues forward into ...



Bathroom: Against the aft bulkhead is a corner unit with inset basin and open storage below. Cassette toilet. Hip bath at the forward end with curtain and shower over. Passageway continues forward into ...

Galley: Located to port with beige work surface and storage cupboards below and above. Inset single bowl stainless steel sink. Free standing Valor 4 gas hob burner with grill and oven. Small Russell 240v fridge below work surface. Section of work surface to starboard. Open plan forward into ...



Saloon: To port is a day bed with storage below, this can be used as a sofa, single bed our can convert to a double. To starboard is a large radiator, TV mounted on the wall and the solid fuel stove at the forward end. Large cupboard to port. Step up to forward well

This boat has been cleared and will be sold as viewed.

GENERAL

Berth transferable: Possible cruising berth by arrangement

Sale type: Private

VAT status: The VAT status of this vessel is not known.

Viewing: High Line Yachting, Mansion Lane, Iver, SL0 9RG
9am to 6pm Tuesday to Saturday, 11am to 5pm Sunday, closed Monday.

PLEASE NOTE

In this case we are acting as Brokers only.

Whilst every care has been taken in their preparation, the correctness of these particulars is not guaranteed.

The particulars are intended only as a guide and they do not constitute a term of any contract.

A prospective buyer is strongly advised to check the particulars and where appropriate at his own expense to employ a qualified Marine Surveyor to carry out a survey and / or to have an engine trial conducted which if conducted by us shall not imply any liability for such engine on our part.

The Vendor is not selling in the course of a business.

The VAT status of the vessel is not known, unless otherwise stated.

All sales subject to contract. No guarantee is given or implied as to the condition or legal title.

No appliances or systems have been tested. All measurements stated are approximate.

© Virginia Currer Marine Ltd 2018

Accredited members of

