

Virginia Currer Marine Ltd

Tel: 01753 652502

Mob: 07860 480079

Inland Waterway Specialists

The Boatyard, Mansion Lane, Iver, Buckinghamshire, SL0 9RG

Email: jc@vcmarine.co.uk

Web: www.vcmarine.co.uk

GONGOOZLER'S DREAM [DRAFT]

£139,000

General.

Builder: Aintree Boats

Type: Wide Beam

Fitted: New Concept Boats

Year: 2016

Length: 70ft (21m)

Beam: 12ft (3.65m)

Draught: c2ft (0.6m)

Lying: High Line Yachting, Northolt, with residential mooring.

CRT no: 524518

CIN No: GB-NCB70ANBK616

BSC to: Exempt for two years

History

This vessel is lying on a residential berth at Northolt (please see mooring information below). Two large cabins one fitted as a double cabin and the other can be used as a double berth, office etc.. Solid wood flooring and work surfaces. Hydraulic wheel steering. Prepared to take a sound system with roof mounted marine speakers. Lovely spacious boat with modern fit out.

Hull & Exterior.

Material / build: All steel. Thicknesses: 10 – 6 – 4mm



Exterior: Black bitumen painted hull to rubbing band. Black from rubbing band through side decks. Grey cabin sides with full length black panel and light grey coach line. Roof in dark grey with non slip finish panels in light grey.

Windows: Anodised aluminium top opening plus side doors.

Forward well: Rope fender. Steel cants. Two 'T' studs. Gas locker containing 1 x 13kg gas bottles. Self draining steel well deck with inspection hatch to bowthuster. Two central half glazed varnished timber doors to accommodation.

Roof: Sliding hatch over access aft. 6 mushroom vents, centre eye, pole and plank holder, tunnel light. Double steel hand rails, outside one being integrated and the other tubular. Non-slip finish.

Aft deck: Rope fender, 2 mooring dollies, steel cants, diesel filler. Wheel steering. Self draining deck. Steel frame around stern for security with opening doors to each side. Bench/locker. Two central timber lined steel doors to accommodation.

Mechanical & Electrical.

Engine: Barrus shire twin alternator 4 cyl 70hp *Gearbox:* PRM 260
Hours: 85.6
Bowthruster: Vetus
Cooling: Skin tank
Calorifier feed: Yes
Weed hatch: Quick release *Stern gland greaser:* Water lubricated
Bilge pump: 12v
Batteries: 12v *Domestic:* 4 *Engine:* 1
240v: Yes
Inverter / Charger: Sterling Pro Combi S 2500w / 80amp.
Generator: No

Interior.

Lining - floor to gunwale: Vertical grey painted tongue and groove
Lining - gunwale to ceiling: White painted panelling with oak trims
Lining - ceiling: Horizontal white painted tongue and groove with oak trims
Flooring: Solid wood
Lighting: LED
Cabin heating: Solid fuel stove and Webasto heating radiators.
Insulation: Spray foam
Water heating: Webasto, 240v immersion and engine
Headroom: 6ft 10in

ACCOMMODATION (From aft)

Cabin Arrangement: Saloon, Galley, Bathroom, Cabin, Double Cabin.

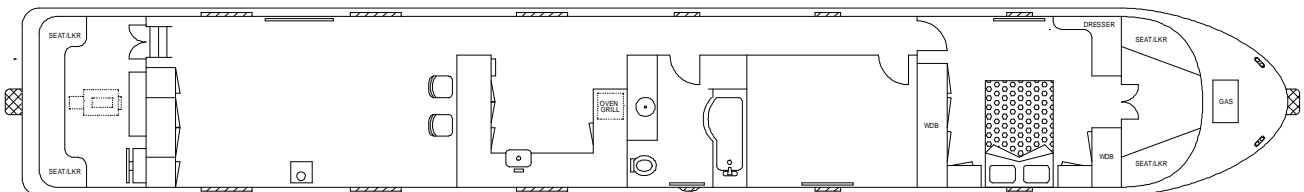

Berth arrangement: 2- fixed double in own cabin

Saloon: Large saloon designed for free standing furniture, currently comprises 2 x two-seater sofas. The current owner has a free-standing 240v fridge and a freezer at the forward end. Space is available in the galley for this on 12v system. At the aft end is a fitted storage unit with cupboards to each side and space for a TV. Open plan forward into ...





Galley: The galley is U shape to starboard, solid wood work surface with matching drawers and cupboards below and above. Butler sink with mixer tap. Space for dishwasher. Against the forward bulkhead is a Belling inset 4 gas hob burners with oven and grill below. Passageway continues forward into ...

Bathroom: Against the aft bulkhead is a full size wardrobe currently housing a washing machine and tumble dryer above. Full size bath with white granite effect splash back, shower over and shower screen. Against the aft bulkhead is a mounted round white basin, black granite effect worksurface with storage below. Pump out toilet. Passageway continues forward into ...



Cabin: Large cabin, designed for free standing furniture, currently used as a kid's room, can take a double bed or can be used as an office. Passageway continues forward into ...

Double Cabin: The walk around bed is located to starboard with fitted bedside tables to each side. The aft bulkhead is a three-door wardrobe, there is another one door wardrobe located at the forward end to starboard. Fitted corner unit to port housing a TV. Steps up to forward well.



This boat has not been cleared and personal possessions will be removed prior to sale.

GENERAL

Berth transferable: Residential berth by arrangement

Sale type: Private

VAT status: The builder has zero rated the boat, as a qualifying ship

Viewing: By Appointment

Other sale considerations:

The residential mooring is located at the High Line Yachting boatyard, Northolt, on the Paddington Arm of the Grand Union. The mooring is amongst a community of other residential boats. Parking is available in the boatyard with a security gate into the yard. A 'key' to the gate, toilet block etc. is available on a deposit.

Facilities offered are 240v electricity connection (charged by meter reading) and water point. BT telephone connection point (subject to the BT connection charge if applicable). Pump out/chemical toilet emptying facilities. Diesel, gas and coal and chandlery are available in the boatyard. Gas and coal deliveries Tuesday and Saturday afternoons. Northolt boatyard is open and staffed on Tuesdays, Thursdays and Saturdays. Toilet and shower block (showers are token operated) with washing machine and tumble dryer (token operated). Incoming post facilities.

Please see HLY website www.high-line.co.uk for full details of the boatyard.

The current mooring rates are as follows:

Paid annually : £100.00 per ft annum

Alternatively this could become:

Paid six monthly : £53.50 per ft half year

Paid monthly : £9.50 per ft month payable by direct debit

A payment of six months' mooring fees in advance will be required as the first payment. A residential licence payable to Canal & River Trust is required. High Line Yachting reserve the right to refuse the transfer of the mooring. Council tax is payable.

Northolt Underground Station which is on the Central Line is within ten minutes' walk. The A40 is within five minutes' drive.

Local E10 Bus stops outside main gate.

Please note – unfortunately no dogs allowed.

PLEASE NOTE

In this case we are acting as Brokers only.

Whilst every care has been taken in their preparation, the correctness of these particulars is not guaranteed.

The particulars are intended only as a guide and they do not constitute a term of any contract.

A prospective buyer is strongly advised to check the particulars and where appropriate at his own expense to employ a qualified Marine Surveyor to carry out a survey and / or to have an engine trial conducted which if conducted by us shall not imply any liability for such engine on our part.

The Vendor is not selling in the course of a business.

The VAT status of the vessel is not known, unless otherwise stated.

All sales subject to contract. No guarantee is given or implied as to the condition or legal title.

No appliances or systems have been tested. All measurements stated are approximate.

© Virginia Currer Marine Ltd 2017

Accredited members of

