



---

## **Mechanical & Electrical.**

Engine: Canaline 52      Gearbox: PRM150      Cooling: Skin tank  
Calorifier feed: Yes      Last service: January 2018  
Bowthruster: Craftsman 95kgf  
Weed hatch: Quick release      Stern gland greaser: Remote  
Bilge pump: 12v  
Batteries: 12v      Domestic: 4      Engine: 1      Bow thruster: 1  
240v: Yes      Inverter/Charger: Victron Multiplus 3000w / 120amp      Generator: No  
Victron Energy Blue Solar MPPT 100/30.

---

## **Interior.**

Lining - floor to gunwale: White painted panelling with sapele hardwood trims  
Lining - gunwale to ceiling: Cream painted panelling with sapele hardwood trims  
Lining - ceiling: White painted panelling with sapele hardwood trims  
Flooring: Hardwood, porcelain tiles in bathroom and carpet in cabins.  
Lighting: LED  
Cabin heating: Solid fuel stove and Webasto heating radiators  
Insulation: Spray foam  
Water heating: Webasto and engine  
Headroom: 6ft 10in

---

## **ACCOMMODATION** (From aft)

Cabin Arrangement: Galley, Saloon, Cabin, Bathroom, Double cabin.

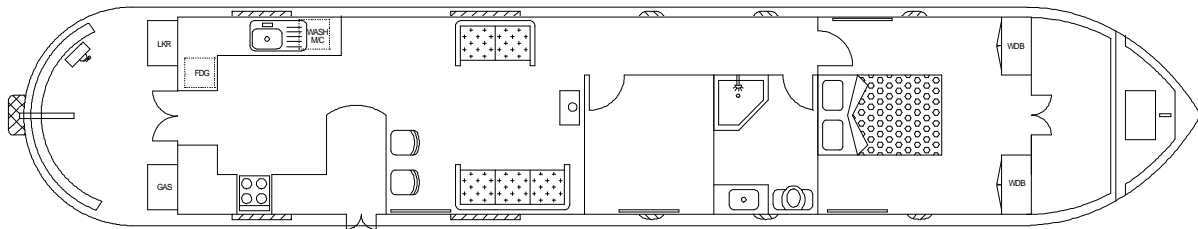

Berth arrangement: 2- free standing double in own cabin.

**Galley:** Steps down from stern in to the galley, organized on both sides of the vessel with sapele hardwood worksurfaces and white cupboards and drawers below. To starboard is an inset Newworld 4 gas hob burner with grill and oven below. Located at the front of the galley is a breakfast bar with two stools. To port is an inset white single bowl sink and drainer unit. Below the worksurface is a LEC fridge and a Beko washing machine. Open plan forward into...





*Saloon:* Designed for free standing furniture, currently comprises a three-seater sofa to starboard and a two-seater sofa to port. The solid fuel stove is located against the forward bulkhead mounted on a brick hearth. Passageway continues forward into ...

*Cabin:* Unfurnished, this can be used as a double cabin or as an office. Passageway continues forward into ...

*Bathroom:* Walls and floor fully tiles in grey, large step in corner shower with opening door. Inset white basin with storage below. Thetford electric flush cassette toilet (not connected). Heated towel radiator. Passageway continues forward into ...



*Double cabin:* The double bed located in the centre of the cabin against the aft bulkhead with interior sprung mattress c.6ft3in x 4ft. Radiator on each side on the cabin. At the forward end to both sides of the steps are full size fitted wardrobes. Steps up to forward well.

This boat has been cleared and will be sold as viewed.

## GENERAL

*Berth transferable:* Temporary cruising berth by arrangement

*Sale type:* Private

*VAT status:* The VAT status of this vessel is not known.

*Viewing:* High Line Yachting, Cowley  
9am to 6pm Tuesday to Saturday.

### PLEASE NOTE

*In this case we are acting as Brokers only.*

*Whilst every care has been taken in their preparation, the correctness of these particulars is not guaranteed.*

*The particulars are intended only as a guide and they do not constitute a term of any contract.*

*A prospective buyer is strongly advised to check the particulars and where appropriate at his own expense to employ a qualified Marine Surveyor to carry out a survey and / or to have an engine trial conducted which if conducted by us shall not imply any liability for such engine on our part.*

*The Vendor is not selling in the course of a business.*

*The VAT status of the vessel is not known, unless otherwise stated.*

*All sales subject to contract. No guarantee is given or implied as to the condition or legal title.*

*No appliances or systems have been tested. All measurements stated are approximate.*

© Virginia Curren Marine Ltd 2017