

RIGHT TO ROAM [DRAFT]

£55,000

General.

Builder: Floating Homes*Type:* Widebeam*Fitted:* Upware Marina*Year:* 2002*Length:* 55ft (m)*Beam:* 10ft 6in (m)*Draught:* c2ft (0.6m)*Lying:* High Line Yachting, Iver*CRT no:* 521500*CIN No:* GB-UPW00137*BSC to:* 11/2018

History

This boat was last out of the water in January 2018 at which time the hull was blacked with bitumen and new anodes fitted at the same time a new Barrus Shire 50 engine was installed.

This vessel is in need of interior work.

Hull & Exterior.

Material / build: All steel. Thicknesses: 10 – 6 – 4mm



Exterior: Black bitumen painted hull to rubbing band. Green from rubbing band through side decks, with non slip finish to side decks. Green cabin sides and roof with name sign written on cabin side at the forward end.

Windows: To port, 4 side opening windows, one porthole and large opening side doors. To starboard, 5 side opening windows and one porthole. Two skylights, one in saloon and the other in double cabin.

Forward well: Rope fender. Steel cants. 'T' stud. Self draining steel well deck with inspection hatch to integral water tank below. Storage locker and tunnel light. Two timber lined steel doors accommodation.

Roof: Opening hatch over side doors. Centre eye, 2 mushroom vents, 2 skylights, intergral steel hand rails, plank and solar panels.

Aft deck: Rope fender, 2 mooring dollies, steel cants, diesel filler. Tiller steering. Gas locker containing 3 x 15kg gas bottles. Two timber lined steel doors to starboard into accommodation.

Mechanical & Electrical.

Engine: Barrus Shire 50 Gearbox: PRM Delta Cooling: Skin tank
Calorifier feed: No, but possibility to connect Last service/Hours: New engine
Bowthruster: No
Weed hatch: Quick release Stern gland greaser: Remote
Bilge pump: 12v Auto
Batteries: 12v Domestic: 6 Engine: 1
240v: Yes Inverter: Waeco 200w Charger: Sterling 40amp
Generator: No

Interior.

Lining - floor to gunwale: Tongue and groove
Lining - gunwale to ceiling: Carpet and tongue and groove
Lining - ceiling: Pine tongue and groove
Bulkheads: Mixed
Flooring: Laminate and vinyl
Lighting: Led
Cabin heating: Solid fuel stove with back boiler. This needs servicing and chimney replaced.
Insulation: Spray foam
Water heating: 240v immersion, all the plumbing is there to connect to the engine.
Headroom: 6ft 8in

ACCOMMODATION (From aft)

Cabin Arrangement: Saloon, Galley, Single Cabin, Bathroom, Double cabin.

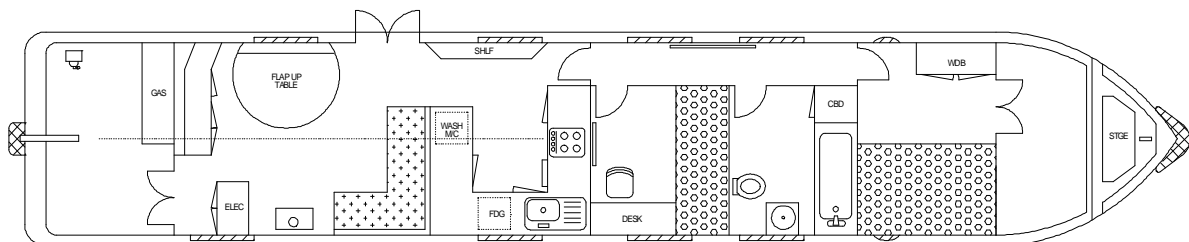

Berth arrangement: 3 - fixed double in own cabin plus single in own cabin.

Saloon: Steps down with door to starboard from stern. As you enter the saloon there is a cupboard unit to starboard. Against the aft bulkhead is a full-length storage unit with the bottom part being cupboards and above shelves. To port mounted is a large foldable table. Fitted L shape sofa and solid fuel stove to starboard. Open plan forward into ...





Galley: The galley is U shape to starboard, granite grey effect work surface with wood fronted cupboards and drawers below and some mounted above. At the forward end is an inset Vanette 4 gas hob burner with grill and oven. To starboard is an inset single bowl stainless steel sink and drainer unit. At the aft end is a microwave and below the work surface a Hotpoint washing machine. Section of open shelves to port. Passageway to port continues forward into ...

Single Cabin: Fully carpeted in grey, floor and walls. The single bed is located against the forward bulkhead with storage below and shelf unit above. To starboard is a built-in desk with chair. Passageway continues to port forward into ...



Bathroom: Fully tiled in white with vinyl floor. Full size bath against the forward bulkhead, also there is a cupboard housing the calorifier. To port is a round white basin with mixer tap. Against the aft bulkhead is a free-standing chest of drawers, mounted on the wall is a large mirror and further a towel radiator. Passageway continues forward into ...

Double Cabin: The double bed is lengthways to starboard with storage drawers below. Mounted on the forward bulkhead is a shelf unit with a small TV above. To port is a two door wardrobe with hanging space and open storage below.



This boat has been cleared and will be sold as viewed.

GENERAL

Berth transferable: Possible cruising berth by arrangement

Sale type: Private

VAT status: The VAT status of this vessel is not known.

Viewing: High Line Yachting, Mansion Lane, Iver, SL0 9RG
9am to 6pm Tuesday to Saturday, 11am to 5pm Sunday, closed Monday.

PLEASE NOTE

In this case we are acting as Brokers only.

Whilst every care has been taken in their preparation, the correctness of these particulars is not guaranteed.

The particulars are intended only as a guide and they do not constitute a term of any contract.

A prospective buyer is strongly advised to check the particulars and where appropriate at his own expense to employ a qualified Marine Surveyor to carry out a survey and / or to have an engine trial conducted which if conducted by us shall not imply any liability for such engine on our part.

The Vendor is not selling in the course of a business.

The VAT status of the vessel is not known, unless otherwise stated.

All sales subject to contract. No guarantee is given or implied as to the condition or legal title.

No appliances or systems have been tested. All measurements stated are approximate.

© Virginia Currer Marine 2018

Accredited members of

