

Virginia Currer Marine Ltd

Tel: 01753 652502

Mob: 07860 480079

Inland Waterway Specialists

The Boatyard, Mansion Lane, Iver, Buckinghamshire, SL0 9RG

Email: jc@vcmarine.co.uk

Web: www.vcmarine.co.uk

BRENDON II [DRAFT]

£34,500

General.

Builder: Liverpool Boats

Type: Semi-Traditional stern

Fitted: Liverpool Boats

Year: 1997

Length: 58ft (18m)

Beam: 6ft 10in (2.1m) *Draught:* c2ft (0.6m)

Lying: High Line Yachting, Iver

CRT no: 501326

CIN No: N/A

BSC to: New will be issued

History

This vessel was last out of the water in 2017 for blacking with bitumen and anodes were found to adequate, at the same time a hull survey was carried out. The recommendations raised were addressed. In July 2017 the superstructure was repainted.

Hull & Exterior.

Material / build: All steel. Thicknesses: 10 - 6 - 4mm



Exterior: Black bitumen painted hull to rubbing band. Blue from rubbing band through side decks and cabin sides, with non slip finish to side decks. Roof in light grey.

Windows: Port: 3 Anodised aluminium top hopper opening, 1 porthole, 1 side opening plus side doors. Starboard: 2 Anodised aluminium top hopper opening, 1 side opening plus 1 porthole.

Forward well: Rope fender. Steel cants. 'T' stud. Gas locker containing 2 x 13kg gas bottles. Self draining steel well deck with bench/locker to each side. Cratch cover. Two central half glazed varnished timber doors with steel shutters to accommodation.

Roof: Sliding hatch over access aft. 5 mushroom vents, pole and plank holder housing both. Centre eye. Integral steel handrails.

Aft deck: Semi-Traditional stern with storage lockers to each side. 2 mooring dollies, steel cants, diesel filler. Tiller steering. Pram cover. Self draining deck. Two central timber lined steel doors to accommodation.

Mechanical & Electrical.

Engine: Beta Marine 35hp *gearbox:* PRM Delta 20 Hydraulic
Cooling: Skin tank
Calorifier feed: Yes *Last service:* 2015
Bowthruster: No
Weed hatch: Quick release *Stern gland greaser:* Remote
Bilge pump: 12v
Batteries: 12v *Domestic:* 2 *Engine:* 1
240v: Yes *Inverter /Charger:* Interface 1000w 50amp
Generator: No
240v Travel pack installed but currently not functioning.

Interior.

Lining - floor to gunwale: Pine faced paneling with dark trims
Lining - gunwale to ceiling: As above
Lining - ceiling: As above
Bulkheads: As above
Flooring: Carpet in most of the vessel, vinyl laminate effect in bathroom and galley.
Lighting: LED
Cabin heating: Solid fuel stove and radiators heated by Eberspacher
Insulation: Rockwool
Water heating: Eberspacher and engine
Headroom: 6ft 2in

ACCOMMODATION (From aft)

Cabin Arrangement: Double Cabin, Bathroom, Galley, Dinette, Saloon

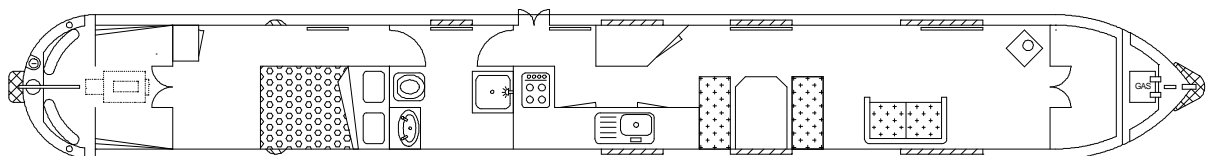

Berth arrangement: 4- double in own cabin plus convertible double in saloon.

Double cabin: Steps down from stern into the cabin with open hanging space to starboard. The double bed is free standing and lengthways to starboard against the forward bulkhead. Reading lamp above the bed. To port is a radiator a shelf unit. Door continues forward into ...





Bathroom: Against the aft bulkhead is an inset white basin with storage below, mirror mounted on the bulkhead. Further in the cassette toilet. Against the forward bulkhead is a step-in shower with folding doors. The bathroom is fully tiled in white. Door continues forward into ...

Galley: The galley is organized on both sides of the vessel, to starboard is a section of marble effect work surface with storage cupboards and Proline fridge below. Inset single bowl stainless steel sink and drainer unit. At the aft end is a red Vanette 4 gas hob burner with grill and oven below. To port is a section of solid wood work surface with cupboards and drawers below. Open plan into ...



Dinette: Pullman style dinette with storage below that can convert to a double berth. Open plan into ...



Saloon: Free standing furniture, to starboard is a two seater sofa and at the forward end is a fitted shelf unit. To port at the aft end is a large shelf unit and further is the solid fuel stove mounted on a black hearth.

This boat has been cleared and will be sold as viewed.

GENERAL

Berth transferable: Possible cruising berth by arrangement

Sale type: Private

VAT status: The VAT status of this vessel is not known.

Viewing: High Line Yachting, Mansion Lane, Iver, SL0 9RG
9am to 6pm Tuesday to Saturday, 11am to 5pm Sunday, closed Monday.

PLEASE NOTE

In this case we are acting as Brokers only.

Whilst every care has been taken in their preparation, the correctness of these particulars is not guaranteed.

The particulars are intended only as a guide and they do not constitute a term of any contract.

A prospective buyer is strongly advised to check the particulars and where appropriate at his own expense to employ a qualified Marine Surveyor to carry out a survey and / or to have an engine trial conducted which if conducted by us shall not imply any liability for such engine on our part.

The Vendor is not selling in the course of a business.

The VAT status of the vessel is not known, unless otherwise stated.

All sales subject to contract. No guarantee is given or implied as to the condition or legal title.

No appliances or systems have been tested. All measurements stated are approximate.

© Virginia Curren Marine Ltd 2017

Accredited members of

